

NEODYMIUM

**SUBWOOFER**

WOOFER

COAXIAL

MEDIUM

DRIVER

# S18L1010

- 2000 Watt Max Power
- 125mm (5 inch) voice coil
- 40Hz to 1.5kHz frequency response
- 100dB 1W@1m sensitivity
- Ferrite magnet structure

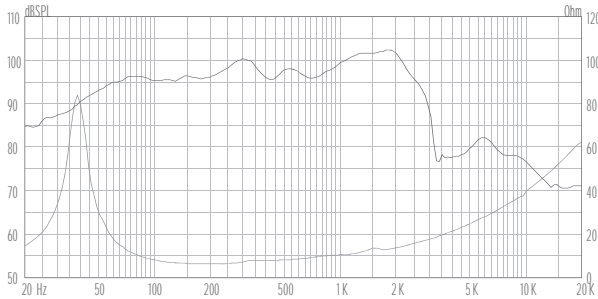

# S18G810

- 1600 Watt Max Power
- 99.5mm (4 inch) voice coil
- 40Hz to 1.5kHz frequency response
- 98dB 1W@1m sensitivity
- Ferrite magnet structure

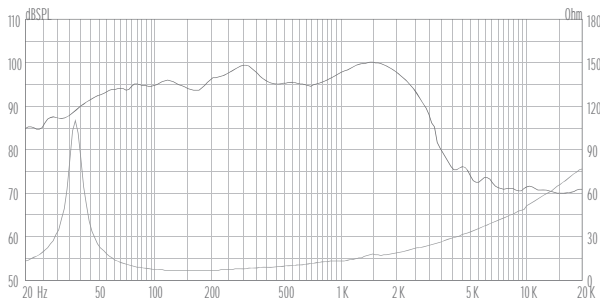

## Specifications

Model		S18L1010	S18G810
Nominal diameter	in.	18	18
Power handling capacity	W(AES)	1000	800
Max power	Watts	2000	1600
Nominal impedance		8	8
Sensitivity (1W/1m)	dB	100	98
Frequency range	Hz	40-1.5k	40-1.5k
Voice coil diameter	mm/in	125/5	99.5/4
<hr/>			
Fs	Hz	41	38
Re		4.5	5.0
Qms		3.58	6.28
Qes		0.29	0.38
Qts		0.27	0.36
Vas	L	136	168
Mms	gr	232	218
Cms	mm/N	0.06	0.08
BL	Tm	30.0	26.4
Le	mH	0.55	0.93
Xmax	mm	7.5	7.4
nO	%	3.2	2.4
Sd	cm <sup>2</sup>	1225	1225
<hr/>			
Overall diameter	mm	462	462
Bolt circle diamete	mm	474	474
Baffle cut-out diameter	mm	435	435
Overall depth	mm	207	210
Net weight	Kg	21	13.6

- AES power is measured with 6dB crest factor continuous pink noise in 2 hours duration.
- Max power is defined as 3dB higher than the nominal rating.
- Sensitivity is measured at one meter at 2.83V and 8 ohm nominal impedance.
- All measurement of the speaker is done after a sufficient high level of 20Hz sine wave test.
- Xmas is defined at the BL drops by 18% of the original figure.

## Dimension Drawings

### S18L1010

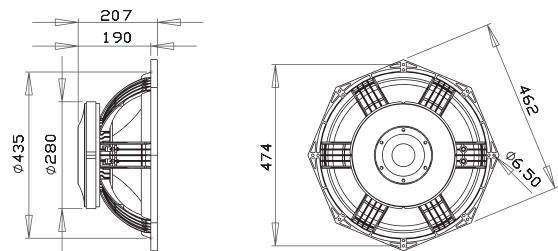

### S18G810

